

ALPHA[®] CONTROLS

ALPHA CONTROLS LTD

WRAS Water Flow SOLENOID VALVES



TAKING CONTROL THROUGH
CUSTOMISED SOLUTIONS

www.alphacontrols.co.uk

WATER FLOW SOLENOID VALVES



Construction, External Dimensions Chart

1	2	3	4	5	6	7	8	9	10
Valve	Mode of Operation	Coil Type	Coil Class	Voltage	Seal Material	Body Material	connect Size	Orifice (mm)	Options
WZS	1	D	F	02	E	1	E	20	
	1= Normally Closed	D-DIN Standard Connections, Fully Encapsulated	F=F Class	02= AC220V AC230V AC 240V 01= AC110V AC120V 05= AC24V 12= DC12V 13= DC24V	E= EPDM	9=brass 1=brass	B=1/4" C=3/8" D=1/2" C=3/8" D=1/2" E=3/4" G=1"	10=10.0 13=13.0 15=15.0 20=20.0 20=20.0 25=25.0	N=NPT Connection P=PT R=RC Blank is G thread



WRAS approval is for manufacturers and distributors of sanitary and plumbing products and components intended for installation in the UK who require their products to be compliance with UK Water Regulation 4.

England & Wales: the Water Supply (Water Fittings) Regulations 1999

Scotland: the Water Supply (Water Fittings) (Scotland) Byelaws 2014

Northern Ireland: the Water Supply (Water Fittings) Regulations (Northern Ireland) 2009

With a WRAS approved product, you know the item is designed and tested to comply with The Water Supply (Water Fittings) Regulations 1999. These regulations ensure the protection of public health, protect the water supplies and the efficient use of water.

And so if your industry works within Process Engineering, food and drink, pharmaceuticals, building and leisure and the water supplied is from the Public water mains through any of your processes then you must comply with WRAS* by Law.

*Wras is the approved seal materials

These new valves from Alpha Controls Ltd fit the bill and are in stock in our Warehouse

WZS Series 2/2-Way Large Diameter Acting Solenoid Valve



2-Way normally closed solenoid valve, Closed when de-energized, open when energized.

Ambient Temp: -10°C~65°C Fluids Temp: 0°C~120°C

Voltage: AC110V/50Hz; AC120/60Hz;
AC220V/50Hz ; AC240V/60Hz,
AC230V 50/60Hz ; AC36V 50/60Hz;
AC24V 50/60Hz ; DC24V ; DC12V ±10%

Flow as the arrow, mounts in any position; Best position is Solenoid vertical and upright direction.



External Dimensions

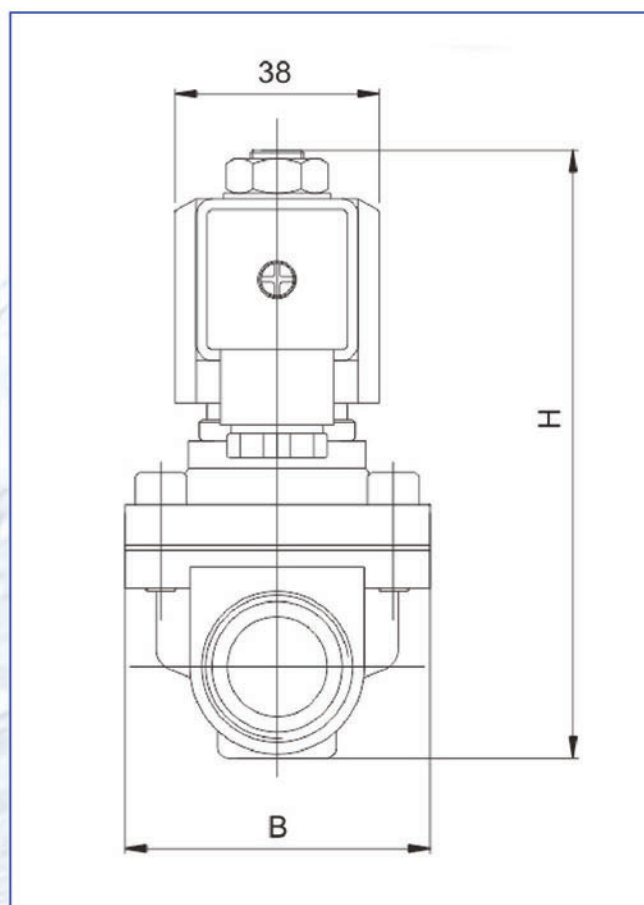
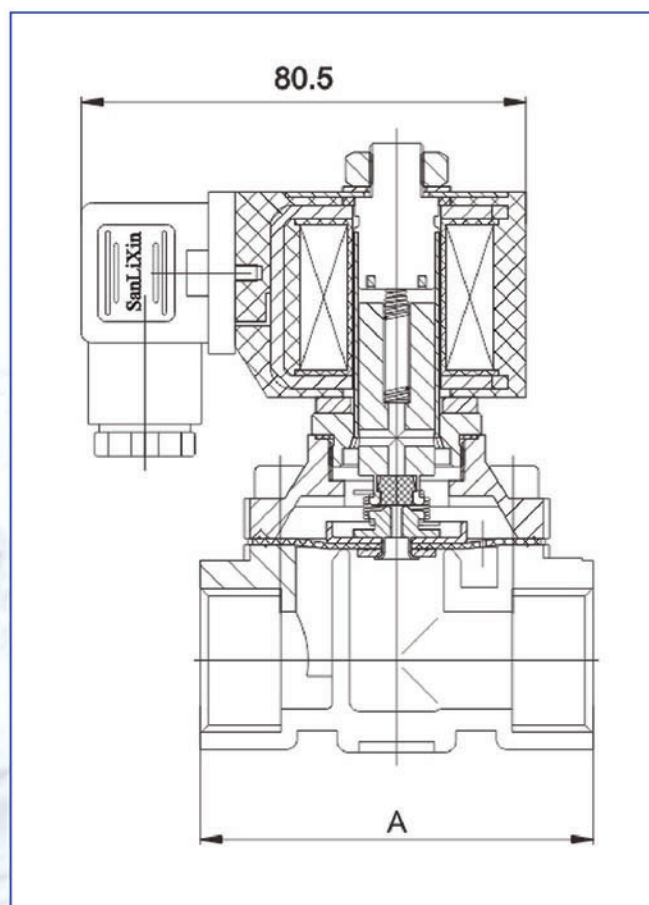

Valve Selection List

ALPHA CONTROLS CODE 200-240 VAC	Pipe	Orifice	CV	Operating pressure differential (PSI)					Max.	Coil	Power consumption		Coil	External Dimensions	Model Code 220VAC	Weight (KG)
	Conn- ection	mm	Factor	Min.	Max.				Temp. °C	Type	VA	W				
					Air		liquid				AC 110V	DC 24V				
SA300 40w	1/2 "	15	4.8	0	8	6	8	6	120	D	20	20	F	69x57x106	WZS1DF02E1D16	0.9
SA300 60w	3/4 "	20	7.6	0	8	6	8	6	120	D	20	20	F	73x57x114	WZS1DF02E1E20	1.1
SA300 70w	1 "	25	12	0	8	6	8	6	120	D	20	20	F	99x77x121	WZS1DF02E1G25	1.4

*Other voltages available as above

TAKING CONTROL THROUGH CUSTOMISED SOLUTIONS

Alpha Controls Ltd is committed to excellent customer service and has established partnerships with many major companies throughout the UK. We have 2 sites in the UK – Wigan in Lancashire and Slough. We are a highly dedicated and experienced team of technicians ensure an excellent customer service across a wide range of industries and applications. It's a service based on sound, objective advice from one of the leading independent companies in this field – Alpha Controls.



Alpha Controls Ltd

Alpha House, Hindley Industrial Estate,
Swan Lane, Hindley Green. Wigan.
WN2 4HR. UK

Telephone: +44 (0)1942 525833

E-mail: technicalsales@alphacontrols.co.uk

www.alphacontrols.co.uk