

Product ID ALV310F3C5





PRODUCT NAME
 Conventional Type Explosion Proof Solenoid Valve

MODEL NO.
 ALV310F3C5

DESCRIPTION OF THE PRODUCT
 Based on NAMUR standard (32×24), the ALV310F3C5 AICHEM NAMUR solenoid valve can be adapted for 3/2 NC or 5/2 functions for controlling double-acting and single-acting pneumatic actuators. This solenoid valve, it is excellent for being used in hazardous area. Working pressure from 2 bar to 8 bar and the working voltage from 12-24VDC, 24-240VAC.



APPROVED BY Solenoid Coil: C5





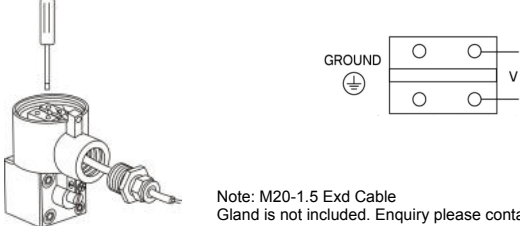

IP67 NEMA4,4X

Operating Voltage 12VDC ≤ 3.5W, 24VDC-3.5W, 24VDC ≤ 1.0W, 24/110/120/220/240VAC-4VA (50/60HZ)

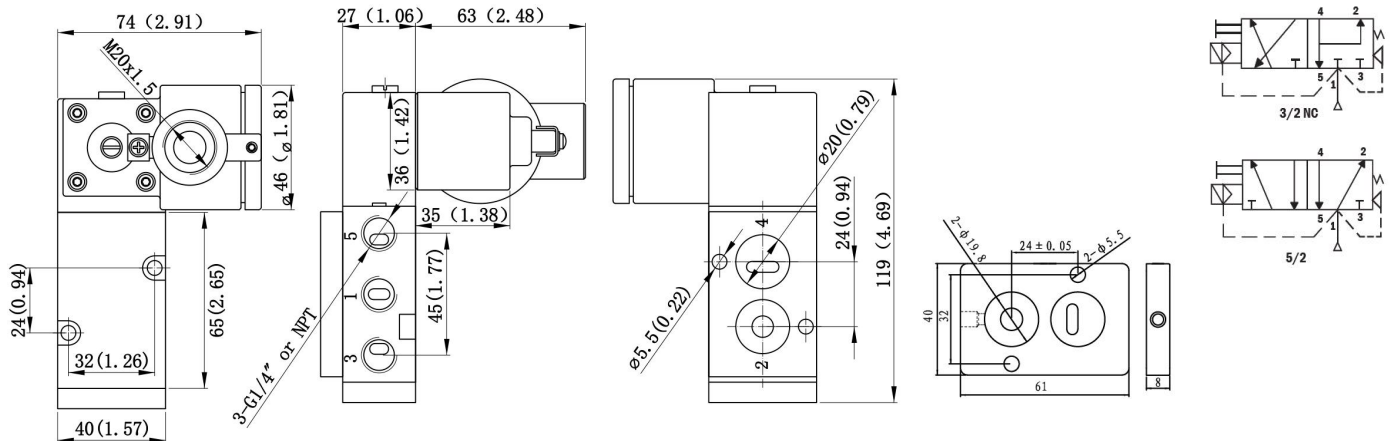
SPECIFICATIONS AND TECHNICAL DATA		Voltage Tolerance	±10%
Spool Valve/Body	Extruded Aluminum	Coil Enclosure	Die-casting Aluminum + Epoxy Coated
Coating	Anodized Coated	Cable Entry	M20-1.5 or 1/2"NPT, Terminal Strip
Seal	Buna N	Insulation Protection	F Class (H Class On Requiring)
Materials in Contact with Fluid	Aluminum, Glass-filled Resin, Buna N	Insulated voltage	1000V
Function	5/2 or 3/2NC, Monostable, Pilot Operation	Duty factor	100% ED
Air Ports	Air Ports G1/4" or NPT	Weather Proof	IP67
Flow Rate	CV =1.4(25.00mm ²)	Area Classification	 II 2 G Ex db IIC T6 Gb
Installation and Connection	24×32 Namur Manual Override On Body	Operating Temp.*	-20℃ ~ 60℃
Fasteners	Stainless Steel	Wiring Diagram	
Environment	Indoor and Outdoor	 <p>Note: M20-1.5 Exd Cable Gland is not included. Enquiry please contact with us.</p>	
Medium Temperature*	-5℃ ~ 80℃		
Working Pressure	2 ~ 8 bar		
Working Medium	Less Than 40µm Filtered and Dried Air		
Bistable (ALV320F3-)	Available On Requiring		
Working Life	More Than 1000,000 Cycle (On The Normal Working Condition)		

* When the operating temp. is different with medium temperature, the one has smaller absolute value must be chose.

DRAWING AND DIMENSION



**For continuous improvement of the product, we reserve the right to alter the dimensions, technical data and information included in this data sheet.



Engineering & Technical Centre, 1 Ormside Close, Hindley Industrial Estate, Hindley Green, Wigan, WN24HR, Greater Manchester, UK, Tel +44 (0) 1942 525833, Technicalsales@alphacontrols.co.uk, www.alphacontrols.co.uk

